

# Moulding Guide



**Drexel**<sup>™</sup>  
MILLWORK & DOORS

# About Drexel Millwork & Doors



People don't buy **WHAT** you do. They buy **WHY** you do it.

**HISTORY** | Different from our competition, Drexel Millwork & Doors (DMD) launched vertical integration within Drexel Building Supply in 2022. From one location in 1985 to nine locations in 2023, our mission has stayed consistent: supply happiness.

**WHY** | Our "why" is aligned around two important things:

1. Our mission to supply happiness.
2. All eleven of our core values:

**ETHICS | WINNING ATTITUDE | RESPECT | DEVELOPMENT | ACCOUNTABILITY | BALANCE | TEAMWORK | COMMUNICATION | CHANGE | HAVE FUN | CONNECTION**

**WHAT** | From wood species, profiles, prefinishing options, and much, MUCH more, we'll help you find exactly what you're looking for.

supply. happiness.

## Table of Contents

<i>Base</i>	6-8
<i>Casing</i>	9-11
<i>Crown</i>	12-13
<i>Miscellaneous</i>	14-15
<i>Boards</i>	16-17

Random Length Wood Mouldings will be shipped based on the breakdown below:

### *Drexel Standards:*

All wood moulding orders are subject to a +/- variance of 10% over or under ordered quantities. The invoice will reflect the quantity shipped.

25% 6' - 8'  
50% 9' - 12'  
25% 13' & Longer

All Knotty Alder mouldings and S4S come in mixed 6'-12' lengths, with most pieces in the 8'-10' range. 12' boards are included as available but should not be expected in high volume. All Knotty Alder 1x8 S4S will be glued for width.

## *POPLAR*

Poplar is characterized as a smooth, tight grain with a relatively soft texture. Because it is a fast-growing, columnar tree, it absorbs minerals from the soil differently than slower-growing hardwoods. It can range from creamy white to “mineral streaks” of olive green, purple, or dark brown/black. This is often called “Rainbow Poplar” and highlights the deep connection between the tree and its environment.



## *MAPLE*

Maple is a dense, heavy hardwood with a very subtle, typically uniform grain. The tree’s wide-spreading branches and high density create a naturally tight grain and unique mineral streaks, which occur as the wood captures nutrients. While the appearance is usually consistent, you’ll often find small dark spots or rare, decorative patterns like “birdseye” or “curly” figures.



## *RED OAK*

Red Oak is known for its prominent, “open” grain pattern, extreme durability, wide, and high contrast. Expect significant tonal shifts and deep ridges that catch stain to highlight the wood’s powerful, symmetrical growth and give Oak its “classic” furniture-grade reputation.



## *KNOTTY ALDER*

Alder is a smaller, more irregular tree compared to the others. It often grows in smaller clusters with a more slender, less formal trunk. Celebrated for its informal charm, Alder features frequent sound knots and pith marks. These are the natural signatures of a smaller, more irregular tree that brings warmth and texture to a space.

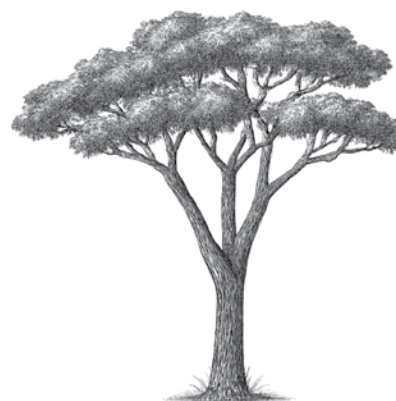

# Finish Options

## *Paint Colors*



*Snow*



*Alpine*



*Salt*



*Greystone*



*Cloud*

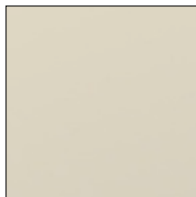

*Linen*



*Parchment*

Our goal is to help you achieve a seamless and harmonious interior. By aligning our millwork factory finish options with a trusted cabinetry manufacturer's palette, we enable you to create a cohesive collection that blends your cabinetry, flooring, and millwork flawlessly. Our partnership ensures that we are always up to date with the latest trends. This allows us to provide you with on trend options that will keep your home looking stylish for years to come.

While this digital/printed guide serves as a beautiful starting point for your design journey, please note that screens and ink cannot perfectly replicate the depth, sheen, and organic texture of our factory-finished millwork. Light interacts differently with wood than it does with pixels. To ensure your vision matches your reality, we strongly recommend making your final color and species selections from the physical samples in one of our showrooms.

## Stain Colors



*Clear*



*Golden*



*Nutmeg*



*Cocoa*



*Drift*



*Saddle*



*Clove*

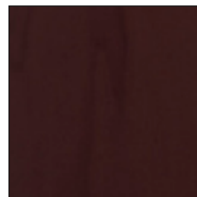

*Espresso*

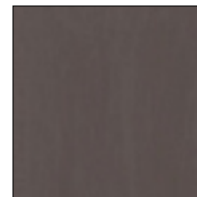

*Graphite*



*Carbon*

This service allows for a high degree of personalization, whether it's drawing inspiration from the extensive Sherwin-Williams color palette, or seeking to replicate an existing hue. The process is designed to ensure accuracy and satisfaction. Customers can provide a physical sample, such as a piece of trim or a color swatch, and skilled technicians will meticulously work to blend it, with up to two attempts if necessary. Physical samples are created to show how the living material of wood varies in grain and color under home lighting. We value precision. If the color is not achieved within two attempts, we will mutually agree to move in a different direction to protect project timelines. For details and pricing, lean on your Drexel Quarterback for more information.

## Ranch & Colonial Base

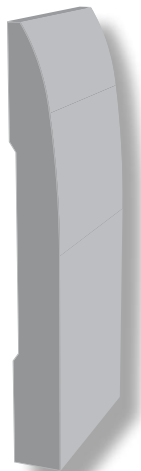

**DMD - 723** -  $\frac{3}{8}$ " x  $3\frac{1}{4}$ "  
O - *RTS*



**DMD - 634** -  $\frac{3}{8}$ " x  $2\frac{3}{4}$ "  
M,O

**DMD - 634** -  $\frac{3}{8}$ " x 3"  
FJP 16' PC



**DMD - 633** -  $\frac{3}{8}$ " x  $3\frac{1}{4}$ "  
M,O,POP - *RTS*

**DMD - 633** -  $\frac{3}{8}$ " x  $3\frac{1}{4}$ "  
FJPOP, FJP 16' PC - *RTS*



**DMD - 623** -  $\frac{1}{2}$ " x  $3\frac{1}{4}$ "  
MDF 16' PC - *RTS*

**DMD - 623** -  $\frac{9}{16}$ " x  $3\frac{1}{4}$ "  
FJP 16' PC



**DMD - 620** -  $\frac{7}{16}$ " x  $4\frac{1}{4}$ "  
O - *RTS*

**DMD - 620** -  $\frac{1}{2}$ " x  $4\frac{1}{4}$ "  
MDF 16' PC

**DMD - 620** -  $\frac{9}{16}$ " x  $4\frac{1}{4}$ "  
FJP 16' PC

KA - Knotty Alder  
M - Maple  
O - Oak  
POP - Poplar  
FJP - FJ Primed Pine  
FJPOP - FJ Primed Poplar  
MDF - Ultra-Lite Primed MDF

PC - Pieces  
LF - Lineal Foot  
*RTS* - Ready To Ship



**DMD - 20136** -  $\frac{9}{16}$ " x  $4\frac{1}{4}$ "  
MDF 16' PC



**DMD - 2808** -  $\frac{9}{16}$ " x  $4\frac{1}{4}$ "  
FJP 16' PC



**DMD - 738** -  $\frac{5}{8}$ " x  $4\frac{1}{4}$ "  
POP - RTS

KA - Knotty Alder  
M - Maple  
O - Oak  
POP - Poplar  
FJP - FJ Primed Pine  
FJPOP - FJ Primed Poplar  
MDF - Ultra-Lite Primed MDF

PC - Pieces  
LF - Lineal Foot  
RTS - Ready To Ship



**DMD - 808** -  $\frac{9}{16}$ " x  $4\frac{1}{4}$ "  
MDF - RTS

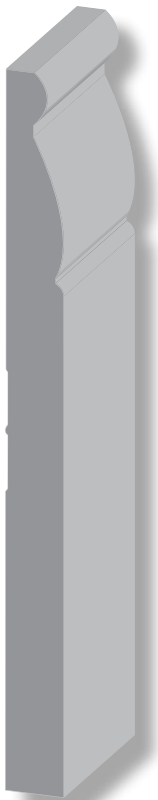

**DMD - 163** -  $\frac{9}{16}$ " x  $5\frac{1}{4}$ "  
MDF 16' PC



**DMD - 2813** -  $\frac{9}{16}$ " x  $5\frac{1}{4}$ "  
FJP 16' PC

## Round Edge Base



**DMD - 434** -  $\frac{3}{8}$ " x  $2\frac{3}{4}$ "  
M,POP



**DMD - 433** -  $\frac{1}{2}$ " x  $3\frac{1}{4}$ "  
MDF 16' PC - *RTS*

**DMD - 433** -  $\frac{3}{8}$ " x  $3\frac{1}{4}$ "  
M,O,POP - *RTS*



**DMD - 314** -  $\frac{5}{8}$ " x  $3\frac{1}{4}$ "  
POP

**DMD - 433** -  $\frac{7}{16}$ " x  $3\frac{1}{4}$ "  
FJP 16' PC - *RTS*



**DMD - 213** -  $\frac{7}{16}$ " x 4"  
M,POP



**DMD - 414** -  $\frac{5}{8}$ " x  $4\frac{1}{4}$ "  
M - *RTS*

**DMD - 430** -  $\frac{1}{2}$ " x  $4\frac{1}{4}$ "  
MDF 16' PC - *RTS*



**DMD - 514** -  $\frac{1}{2}$ " x  $5\frac{1}{4}$ "  
MDF - *RTS*

**DMD - 430** -  $\frac{7}{16}$ " x  $4\frac{1}{4}$ "  
FJP 16' PC - *RTS*

**DMD - 2982** -  $\frac{7}{16}$ " x  $4\frac{1}{4}$ "  
FJPOP - *RTS*

**DMD - 514** -  $\frac{5}{8}$ " x  $5\frac{1}{4}$ "  
M

**DMD - 430** -  $\frac{1}{2}$ " x  $4\frac{1}{4}$ "  
KA,M,O,POP - *RTS*

## Ranch Casing



**DMD - 324** - 1/2" x 2 1/4"  
O 7' PC & LF - RTS

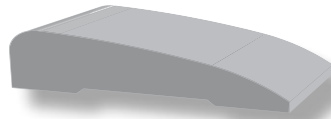

**DMD - 327** - 11/16" x 2 1/4"  
FJP 7' & 14' PC - RTS

KA - Knotty Alder  
M - Maple  
O - Oak  
POP - Poplar  
FJP - FJ Primed Pine  
FJPOP - FJ Primed Poplar  
MDF - Ultra-Lite Primed MDF

PC - Pieces  
LF - Lineal Foot  
RTS - Ready To Ship

## Colonial Casing

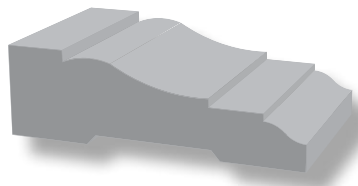

**DMD - 366** - 11/16" x 2 1/4"  
FJP 7' & 14' PC

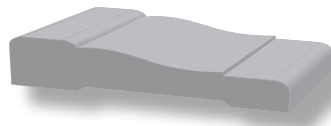

**DMD - 356** - 1/2" x 2 1/4"  
M,O,POP 7' PC & LF - RTS

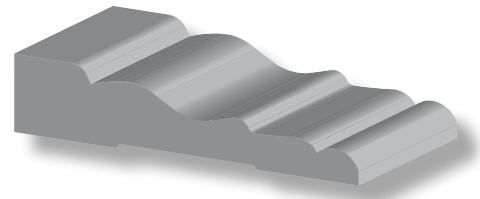

**DMD - 71** - 9/16" x 2 3/4"  
M,POP 7'-3" PC & LF

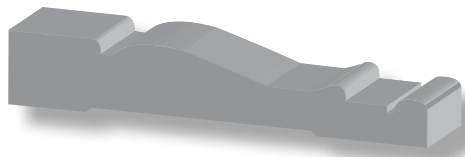

**DMD - 42** - 9/16" x 3 1/4"  
M 7'-6" PC & LF  
O 7'-6" - RTS

**DMD - 356** - 5/8" x 2 1/4"  
MDF 7' & 14' PC - RTS

**DMD - 356** - 11/16" x 2 1/4"  
FJP 7' & 14' PC - RTS

**DMD - 9000** - 1/2" x 2 1/4"  
FJPOP 7' & 14' PC - RTS

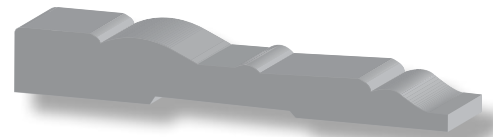

**DMD - 443** - 9/16" x 3 1/4"  
O 7'-6" PC & LF

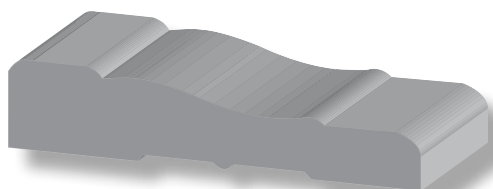

**DMD - 444** - 19/32" x 3 1/4"  
FJP 16' PC - RTS

**DMD - 444** - 19/32" x 3 1/4"  
MDF 7'-6" & 16' PC

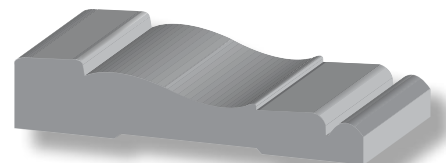

**DMD - MC47** - 3/4" x 3 1/4"  
POP 7'-6" PC & LF - RTS

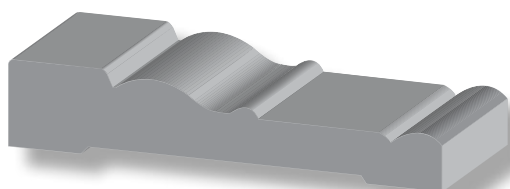

**DMD - 24112 C** - 11/16" x 3 1/2"  
MDF 16' PC - RTS

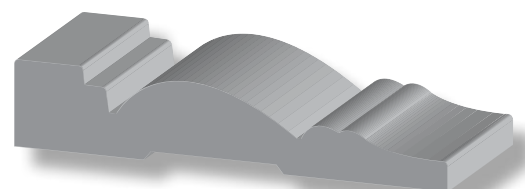

**DMD - 24112 P** - 11/16" x 3 1/2"  
MDF 16' PC

# Casing

## Round Edge Casing



**DMD - 493L** -  $\frac{7}{16}$ " x  $2\frac{1}{4}$ "  
POP 7' PC & LF



**DMD - 493** -  $\frac{1}{2}$ " x  $2\frac{1}{4}$ "  
M,O,POP 7' PC & LF - RTS



**DMD - 473** -  $\frac{9}{16}$ " x  $2\frac{1}{4}$ "  
FJP 7' & 14' PC - RTS



**DMD - 472** -  $\frac{9}{16}$ " x  $2\frac{1}{2}$ "  
FJP 16' PC

**DMD - 473** -  $\frac{19}{32}$ " x  $2\frac{1}{4}$ "  
MDF 7'-6" & 15' PC - RTS

**DMD - 472** -  $\frac{19}{32}$ " x  $2\frac{1}{2}$ "  
MDF 8' & 16' PC - RTS



**DMD - 234** -  $\frac{3}{4}$ " x  $2\frac{3}{4}$ "  
POP 7'-6" PC & LF - RTS

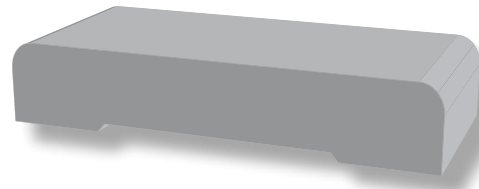

**DMD - 413** -  $\frac{5}{8}$ " x  $3\frac{1}{4}$ "  
M 7'-6" PC & LF - RTS  
KA,O,POP 7'-6" PC & LF - RTS

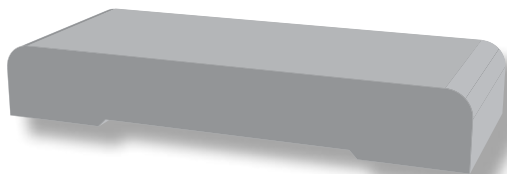

**DMD - 432M** -  $\frac{7}{16}$ " x  $3\frac{1}{2}$ "  
MDF 16' PC

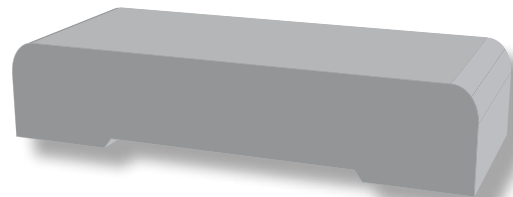

**DMD - 14E2ELM** -  $\frac{11}{16}$ " x  $3\frac{1}{2}$ "  
MDF 16' PC - RTS

**DMD - 432** -  $\frac{9}{16}$ " x  $3\frac{1}{2}$ "  
FJP 7'-6" & 16' PC - RTS

**DMD - 412** -  $\frac{3}{4}$ " x  $3\frac{1}{2}$ "  
M 7'-6" PC & LF

**DMD - 433** -  $\frac{9}{16}$ " x  $3\frac{1}{4}$ "  
FJPOP 7'-6" & 16' PC - RTS

## Modern Casing

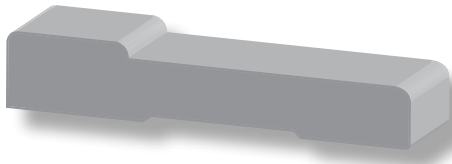

**DMD - 109** -  $\frac{1}{2}$ " x  $2\frac{3}{4}$ "  
M, POP 7'-6" PC & LF  
POP 7'-6" PC & LF - *RTS*

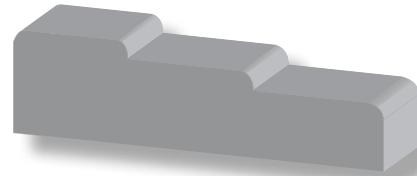

**DMD - 234V** -  $\frac{3}{4}$ " x  $2\frac{3}{4}$ "  
POP 7'-6" PC & LF

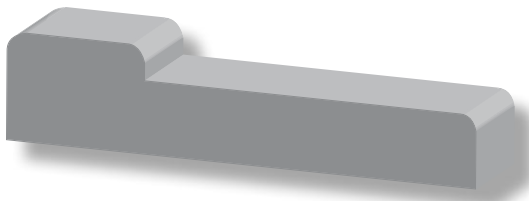

**DMD - 300** -  $\frac{3}{4}$ " x 3"  
M 8' PC & LF - *RTS*

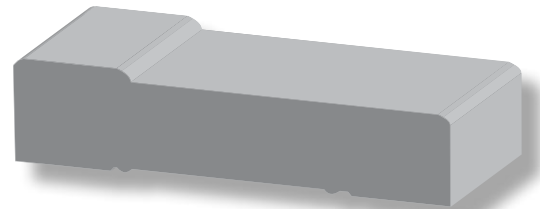

**DMD - 421** -  $\frac{11}{16}$ " x  $3\frac{1}{4}$ "  
MDF 7'-6" & 16' PC - *RTS*

KA - Knotty Alder  
M - Maple  
O - Oak  
POP - Poplar  
FJP - FJ Primed Pine  
FJPOP - FJ Primed Poplar  
MDF - Ultra-Lite Primed MDF

PC - Pieces  
LF - Lineal Foot  
*RTS* - Ready To Ship

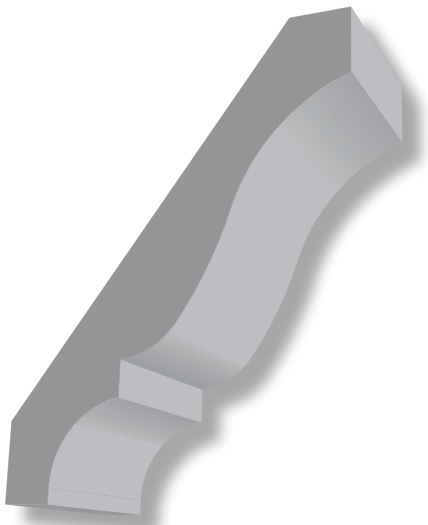

***DMD - 51*** -  $\frac{9}{16}$ " x  $3\frac{1}{4}$ "  
FJP 16' PC - *RTS*

***DMD - 51*** -  $\frac{3}{4}$ " x  $3\frac{1}{4}$ "  
O,POP LF - *RTS*

***DMD - 51*** -  $\frac{5}{8}$ " x  $3\frac{5}{16}$ "  
MDF 16' PC

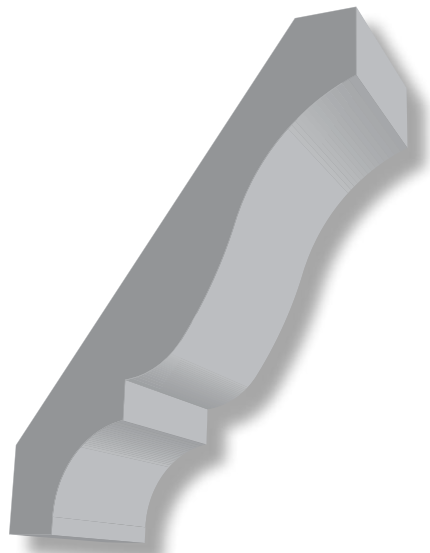

***DMD - 49*** -  $\frac{9}{16}$ " x  $3\frac{9}{16}$ "  
MDF 16' PC

***DMD - 49*** -  $\frac{9}{16}$ " x  $3\frac{5}{8}$ "  
FJP 16' PC

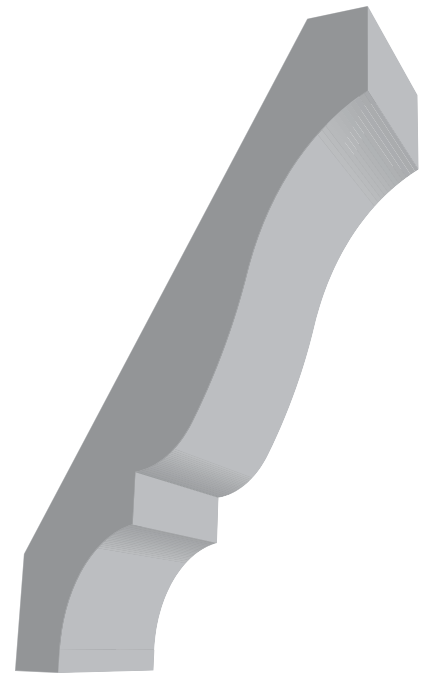

***DMD - 48*** -  $\frac{5}{8}$ " x  $4\frac{1}{4}$ "  
POP LF - *RTS*

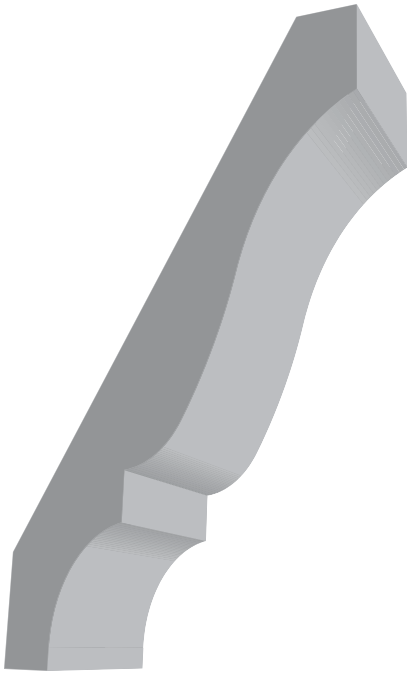

***DMD - 47 -  $\frac{9}{16}$ " x  $4\frac{9}{16}$ "***  
***FJP 16' PC***

***DMD - 47 -  $\frac{9}{16}$ " x  $4\frac{5}{8}$ "***  
***MDF 16' PC***

***DMD - 47 -  $\frac{11}{16}$ " x  $4\frac{5}{8}$ "***  
***O LF***

***DMD - 47 -  $\frac{11}{16}$ " x  $4\frac{5}{8}$ "***  
***M LF***

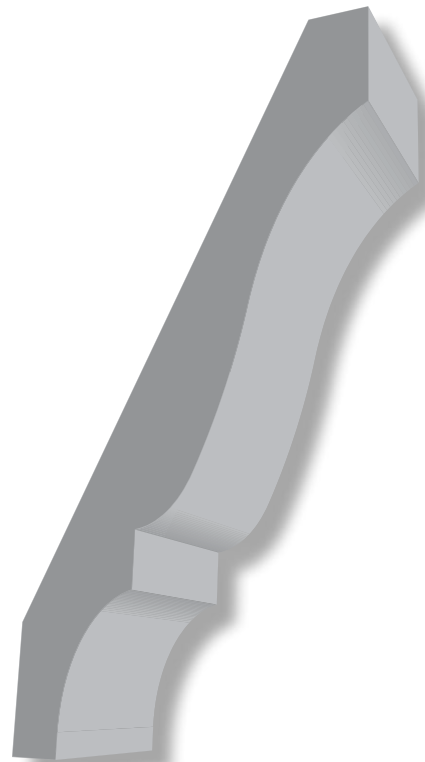

***DMD - 45 -  $\frac{9}{16}$ " x  $5\frac{1}{4}$ "***  
***FJP 16' PC***

***DMD - 45 -  $\frac{9}{16}$ " x  $5\frac{1}{4}$ "***  
***MDF 16' PC***

**KA - Knotty Alder**  
**M - Maple**  
**O - Oak**  
**POP - Poplar**  
**FJP - FJ Primed Pine**  
**FJPOP - FJ Primed Poplar**  
**MDF - Ultra-Lite Primed MDF**

*PC - Pieces*  
*LF - Lineal Foot*  
*RTS - Ready To Ship*

# Miscellaneous

## Backband

## Base Shoe



**DMD - 4422 - 3/4" Rabbet**  
1 1/16" x 1 1/2"  
POP LF

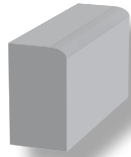

**DMD - 254 - Craftsman**  
7/16" x 3/4"  
FJP 16' PC - RTS

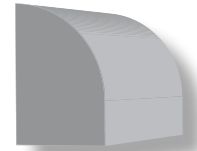

**DMD - 126 - 1/2" x 3/4"**  
M,O,POP LF - RTS  
FJP,FJPOP 16' PC - RTS

## Chair Rail

## Corner Guard

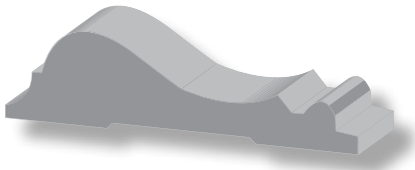

**DMD - 390 - 1 1/16" x 2 5/8"**  
FJP 16' PC

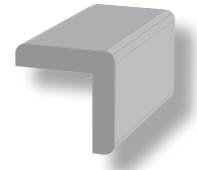

**DMD - 206 - 3/4" x 3/4"**  
O 8' PC

## Cove

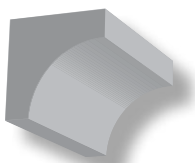

**DMD - 93 - 3/4" x 3/4"**  
O 8' PC & LF

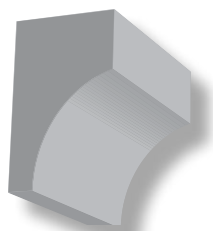

**DMD - 94 - 1 1/16" x 1 1/8"**  
O,POP 8', 12' PC

## Mullion Casing



**DMD - 962** -  $\frac{3}{16}$ " x 2"  
M LF  
O 8' PC & LF  
POP 7' PC

**DMD - 264** -  $\frac{1}{4}$ " x 2"  
FJPOP 16' PC - *RTS*

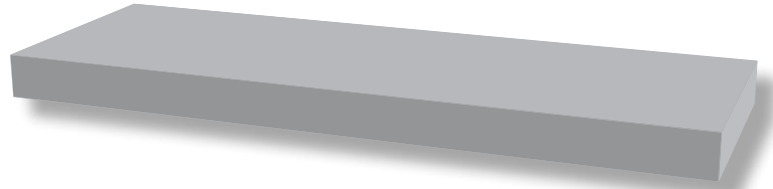

**DMD - 960** -  $\frac{1}{4}$ " x 4"  
O LF  
POP 8' PC

**DMD - 614** -  $\frac{1}{4}$ " x 6"  
POP 10' PC - *RTS*

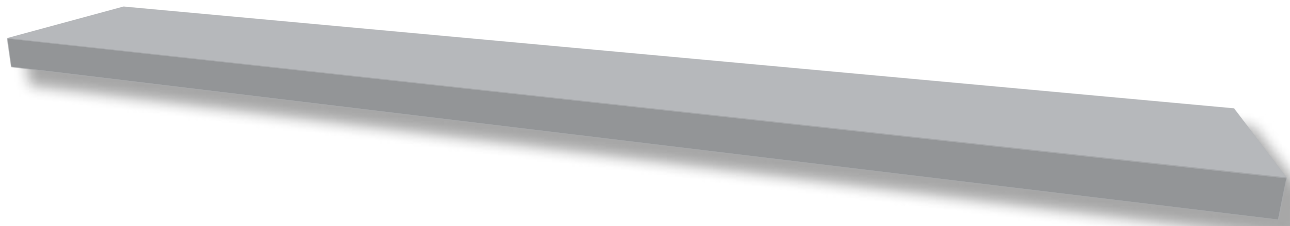

**DMD - 714** -  $\frac{1}{4}$ " x  $7\frac{1}{4}$ "  
M 8' PC

**DMD - 914** -  $\frac{1}{4}$ " x  $9\frac{1}{4}$ "  
M,O,POP 10' PC

## Pediment Moulding



**DMD - 953L** -  $\frac{3}{8}$ " x  $1\frac{3}{8}$ "  
POP LF

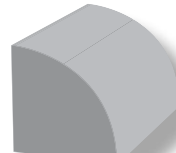

**DMD - 106** -  $\frac{11}{16}$ " x  $\frac{11}{16}$ "  
O 8', 12' PC

## Stop

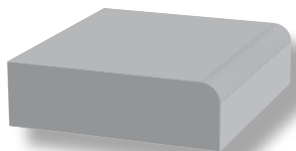

**DMD - 887** -  $\frac{3}{8}$ " x  $1\frac{1}{4}$ "  
M,O,POP 8' PC - *RTS*  
M,O,POP 6'-8" PC & LF

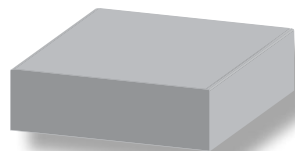

**DMD - 887** -  $\frac{3}{8}$ " x  $1\frac{1}{4}$ "  
FJP 6'-8", 8' PC  
FJP 17' PC - *RTS*

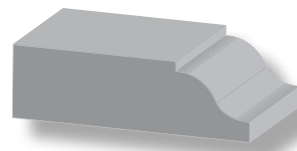

**DMD - 947** -  $\frac{3}{8}$ " x  $1\frac{1}{4}$ "  
M,O,POP 8' PC - *RTS*  
M,O,POP 6'-8" PC & LF

**DMD - 947P** -  $\frac{3}{8}$ " x  $1\frac{1}{4}$ "  
FJP,FJPOP 16' PC - *RTS*

KA - Knotty Alder  
M - Maple  
O - Oak  
POP - Poplar  
FJP - FJ Primed Pine  
FJPOP - FJ Primed Poplar  
MDF - Ultra-Lite Primed MDF

PC - Pieces  
LF - Lineal Foot  
*RTS* - Ready To Ship

# Boards

## Veneer - Boards

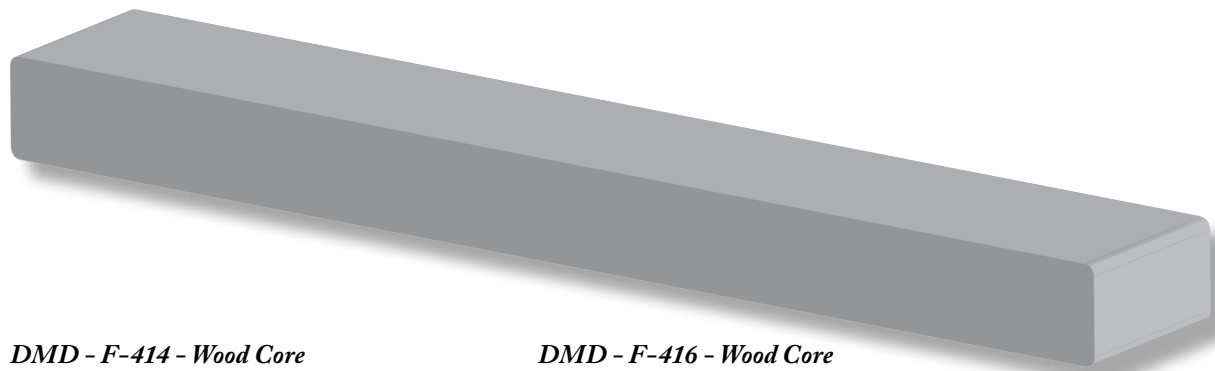

**DMD - F-414 - Wood Core**

**1 x 10 - 3/4" x 9 1/4"**

**M 16' PC**

**M 18' PC - RTS**

**O, POP 16' & 18' PC**

**DMD - F-416 - Wood Core**

**1 x 12 - 3/4" x 11 1/4"**

**POP 18' PC**

## Veneer - Skirtboards

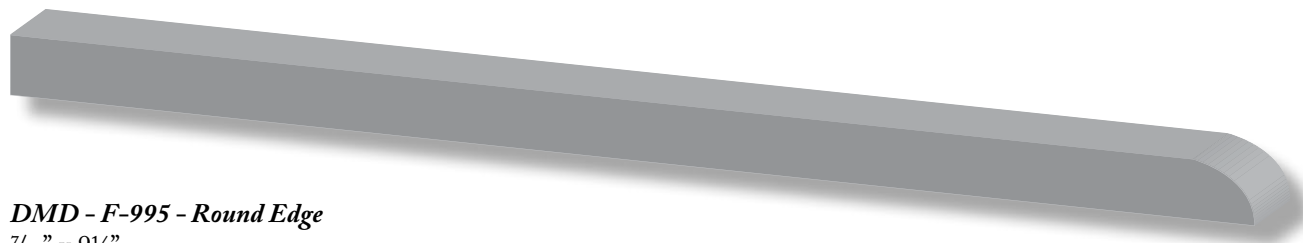

**DMD - F-995 - Round Edge**

**7/16" x 9 1/4"**

**M, O 16' & 18' PC**

**POP 18' PC**

**FJP particle core 18' PC**

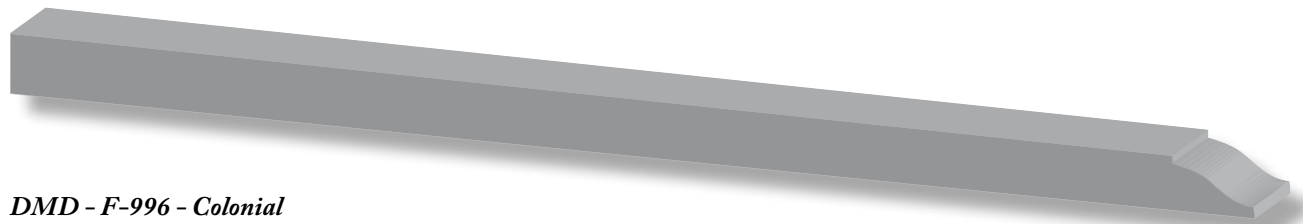

**DMD - F-996 - Colonial**

**7/16" x 9 1/4"**

**M 18' PC**

**POP 18' PC - RTS**

**FJP particle core 18' PC**

## Shiplap

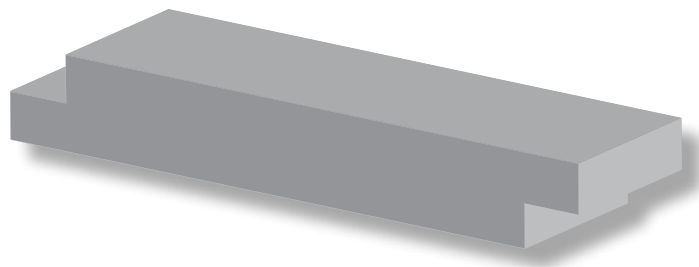

**DMD - 1 x 6 - 1/2" x 5 1/2"**  
MDF 16' PC - RTS

**DMD - 1 x 8 - 1/2" x 7 1/4"**  
FJP, MDF 16' PC - RTS

## S4S Boards

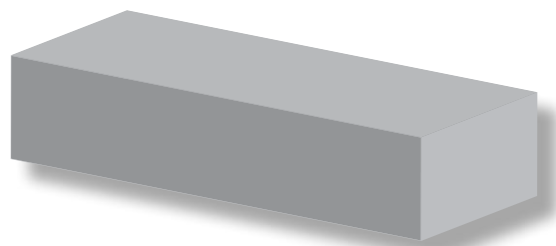

**DMD - 1 x 2 - 3/4" x 1 1/2"**  
M, POP 4' - 16' lengths  
FJP 16' lengths

**DMD - 1 x 3 - 3/4" x 2 1/2"**  
POP 4' - 16' lengths

**DMD - 1 x 4 - 3/4" x 3 1/2"**  
KA 4' - 12' lengths  
M, O, POP 4' - 16' lengths  
FJP, MDF 16' lengths

**DMD - 1 x 5 - 3/4" x 4 5/8"**  
POP 4' - 16' lengths

**DMD - 1 x 6 - 3/4" x 5 1/2"**  
KA 4' - 12' lengths  
M, O, POP 4' - 16' lengths  
FJP, MDF 16' lengths

**DMD - 1 x 8 - 3/4" x 7 1/4"**  
KA 4' - 12' lengths  
M, O, POP 4' - 16' lengths  
FJP, MDF 16' lengths

**DMD - 1 x 10 - 3/4" x 9 1/4"**  
M, O, POP 4' - 16' lengths  
FJP, MDF 16' lengths

**DMD - 1 x 12 - 3/4" x 11 1/4"**  
M, O, POP 4' - 16' lengths  
FJP, MDF 16' lengths

KA - Knotty Alder  
M - Maple  
O - Oak  
POP - Poplar  
FJP - FJ Primed Pine  
FJPOP - FJ Primed Poplar  
MDF - Ultra-Lite Primed MDF

PC - Pieces  
LF - Lineal Foot  
RTS - Ready To Ship

# More Drexel Products

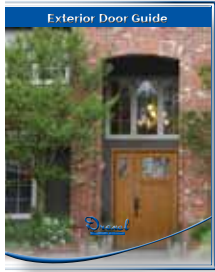

Exterior Doors



Interior Doors



Stair Parts



Mantles

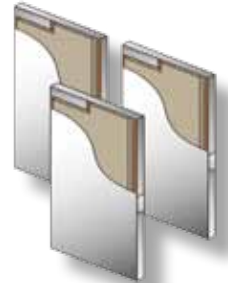

Hollow Metal  
Doors & Frames

**Drexel**<sup>TM</sup>  
MILLWORK & DOORS