

Interior Door Guide



DrexelTM
MILLWORK & DOORS

About Drexel Millwork & Doors



People don't buy WHAT you do. They buy WHY you do it.

Different from our competition, Drexel Millwork & Doors (DMD) launched vertical integration within Drexel Building Supply in 2022. From one location in 1985 to nine locations currently, our mission has stayed consistent: supply happiness.

WHY | Our "why" is aligned around two important things:

- 1. Our mission to supply. happiness.**
- 2. All eleven of our core values:**

**ETHICS | WINNING ATTITUDE | RESPECT | DEVELOPMENT | ACCOUNTABILITY |
BALANCE | TEAMWORK | COMMUNICATION | CHANGE | HAVE FUN | CONNECTION**

WHAT | From wood species, profiles, prefinishing options, and much, MUCH more, we'll help you find exactly what you're looking for.

supply. happiness.



**BDF-1000 Top Mount
Single Wheel**



**BDF-1100 Face
Mount Strap Wheel**



**BDF-1200 Face Mount
Bent Strap Wheel**

- For use with 1³/₈" - 1³/₄" solid core doors.
- Maximum door weight is 165 lbs.
- Soft-close kit available.



F8114



FP-800



PL53

Barn Door Hardware Colors Available:



Satin Nickel
RTS



Matte Black
RTS

RTS - Ready To Ship

Trendy | Innovative | Functional

Interior Door Guide © 2024 Drexel Millwork & Doors

Molded Panel Series



**2-Panels Square
Top
Smooth
RTH**



**2-Panels
Roman
Smooth
RTH**



**6-Panels
Smooth
RTH**



**Craftsman III™
Smooth
RTH**



Personalize your interior door to reflect your unique style:

**2 & 6-Panel Square Top
2-Panel Roman
3-Panel Craftsman III**



RTH - Ready To Hang

Simple | Traditional | Timeless

Interior Door Guide © 2024 Drexel Millwork & Doors

Classic



Cheyenne®
Smooth



Logan®
Smooth
RTH



Riverside®
Smooth



*Feature lines distinguish
the architectural
correctness of authentic
stile and rail wood doors.*

Authentic | Diverse | Stylish

Flush Series



Birch
HC & SC
RTH



Red Oak
HC & SC
RTH



Primed Hardboard
HC & SC
RTH



- A perfect option for small budget renovations.
- Offers the beauty and refinement of an authentic woodgrain finish.
- High-quality materials make doors easy to finish.
- Matching bifolds are available.

Basic | Durable | Low Maintenance

Stile & Rail



1-Panel
#7910
RTH



2-Panels
#7920
RTH



3-Equal Panels
#793H
RTH



3 -Panels
#793E
RTH



5-Panels
#795H
RTH

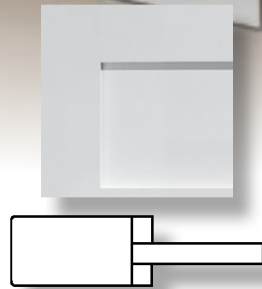

Shaker (Square)
3/8" Flat Panel

Mission style door designs are primed to allow for a better paint finish and color match process for any project.

Interior applications are produced with MDF veneer and panels for superior paintability.

Matching bifolds are available.

Mission Style | MDF Veneer | Wood Core

Stile & Rail

Special Order Primed Doors

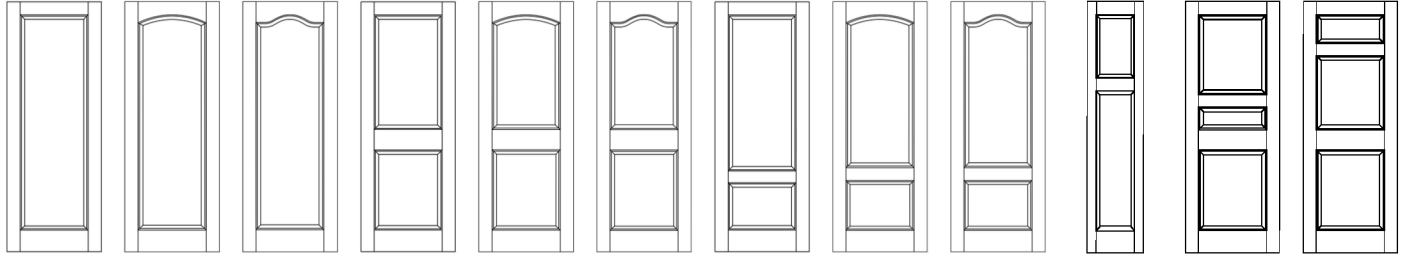

| | | | | | | | | | | | |
|---|--|--|--|---|---|--|---|---|---|--|--|
| 1-Panel #2010 1/0-3/0 | 1-Panel #2010C 1/4-3/0 | 1-Panel #2010S 2/0-3/0 | 2-Panels #2020 1/0-3/0 | 2-Panels #2020C 1/4-3/0 | 2-Panels #2020S 2/0-3/0 | 2-Panels #202A 1/0-3/0 | 2-Panels #202AC 1/4-3/0 | 2-Panels #202AS 2/0-3/0 | 2-Panels #203E 1/0-1/10 | 3-Panels #2035 1/0-3/0 | 3-Panels #2036 1/0-3/0 |
|---|--|--|--|---|---|--|---|---|---|--|--|

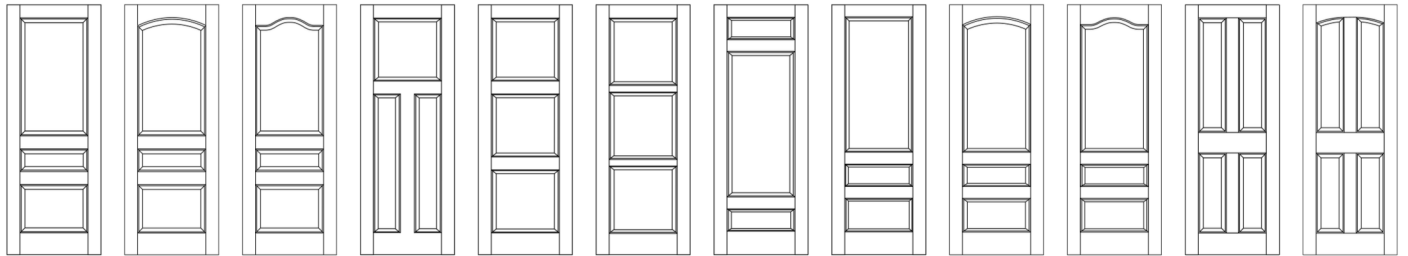

| | | | | | | | | | | | |
|--|---|---|--|--|--|--|--|---|---|--|---|
| 3-Panels #203A 1/0-3/0 | 3-Panels #203AC 1/4-3/0 | 3-Panels #203AS 2/0-3/0 | 3-Panels #203E 2/0-3/0 | 3-Panels #203H 1/0-3/0 | 3-Panels #203L 1/0-3/0 | 3-Panels #203T 1/0-3/0 | 3-Panels #203K 1/0-3/0 | 3-Panels #203KC 1/4-3/0 | 3-Panels #203KS 2/0-3/0 | 4-Panels #2040 2/0-3/0 | 4-Panels #2040C 2/0-3/0 |
|--|---|---|--|--|--|--|--|---|---|--|---|

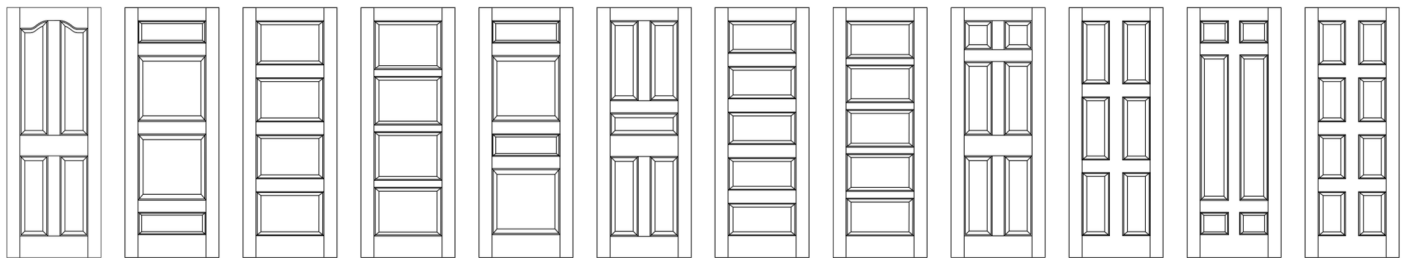

| | | | | | | | | | | | |
|---|--|--|--|--|--|--|--|--|--|--|--|
| 4-Panels #2040S 2/0-3/0 | 4-Panels #204F 1/0-3/0 | 4-Panels #204H 1/0-3/0 | 4-Panels #204L 1/0-3/0 | 4-Panels #204Z 1/0-3/0 | 5-Panels #2050 2/0-3/0 | 5-Panels #205H 1/0-3/0 | 5-Panels #205L 1/0-3/0 | 6-Panels #2060 2/0-3/0 | 6-Panels #206R 2/0-3/0 | 6-Panels #206T 2/0-3/0 | 8-Panels #2080 2/0-3/0 |
|---|--|--|--|--|--|--|--|--|--|--|--|



| | | | |
|--|---|---|--|
| Louver/Louver #730 1 1/4" Slats | Louver/Panel #732 1 1/4" Slats | Louver/Louver #P730 2 3/8" Slats | Louver/Panel #P732 2 3/8" Slats |
|--|---|---|--|

These door styles are available in Ovolo Sticking with 3/8" thick flat panels or 5/8" thick raised panels. Please allow 3-4 weeks lead time.

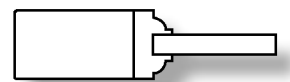

Colonial (Ovolo)
3/8" Flat Panel



Colonial (Ovolo)
5/8" Raised Panel

Primed louver doors are also available with a mirror backing. They are only available with 9/16" thick panels and matching bifolds are block/tapered sticking.

Primed | MDF Veneer | Ovolo Sticking

Special Order Primed Doors

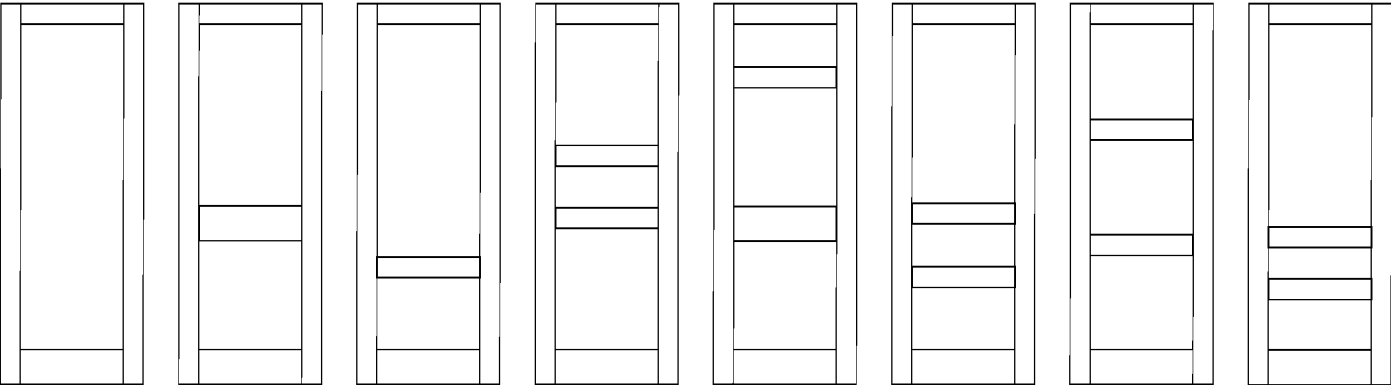

| | | | | | | | |
|--|---|---|---|---|---|---|---|
| 1-Panel #7910 1/0-3/0 | 2-Panels #7920 1/0-3/0 | 2-Panels #792A 1/0-3/0 | 3-Panels #7935 1/0-3/0 | 3-Panels #7936 1/0-3/0 | 3-Panels #793A 1/0-3/0 | 3-Panels #793H 1/0-3/0 | 3-Panels #793K 1/0-3/0 |
|--|---|---|---|---|---|---|---|

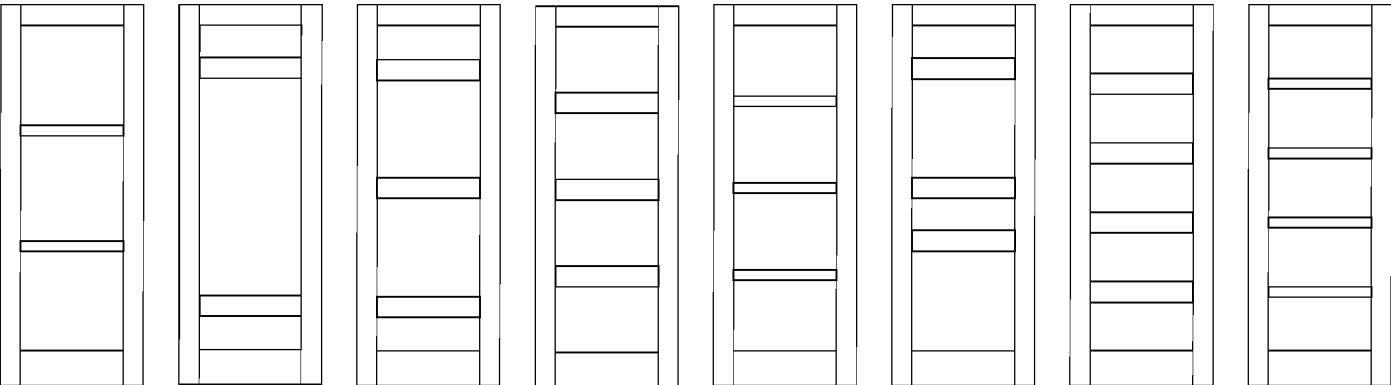

| | | | | | | | |
|---|---|---|---|---|---|---|---|
| 3-Panels #793L 1/0-3/0 | 3-Panels # 793 T 1/0-3/0 | 4-Panels #794F 1/0-3/0 | 4-Panels #794H 1/0-3/0 | 4-Panels #794L 1/0-3/0 | 4-Panels #794Z 1/0-3/0 | 5-Panels #795H 1/0-3/0 | 5-Panels #795L 1/4-3/0 |
|---|---|---|---|---|---|---|---|

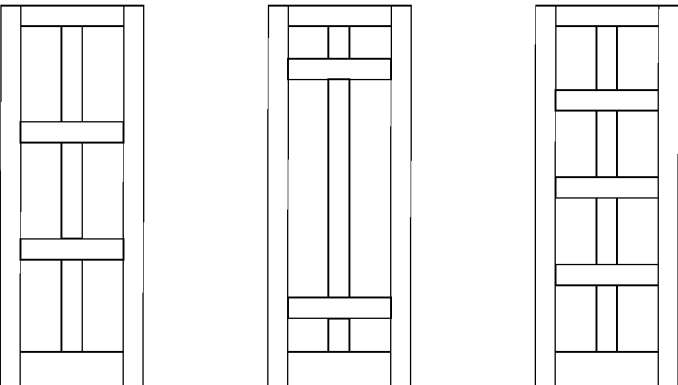

| | | |
|---|---|---|
| 6-Panels #796R 2/0-3/0 | 6-Panels #796T 2/0-3/0 | 8-Panels #7980 2/0-3/0 |
|---|---|---|

These door styles are available in Shaker Sticking with 3/8" thick flat panels. Matching bifolds are also available.

Please allow 3-4 weeks lead time.

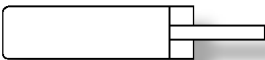

Shaker (Square)
3/8" Flat Panel



New
Shaker E-Sticking
3/8" Flat Panel

Primed | MDF Veneer | Shaker Sticking



**2-Panels
Flat
#4102
RTH**



**2-Panels
Raised
#802**



**3 -Panels
Flat
#4103T
RTH**



**6 Panels
Raised
#108**

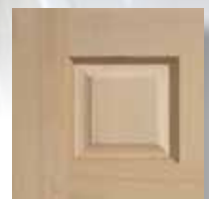

Maple grows in the Eastern United States, offers a very fine grain and a whitish color tinged with redish brown.

Natural | Beautiful | Fine Grain

Red Oak Doors



2-Panels
Raised
#802



2-Panels
Flat
#4102



3-Panels
Flat
#4103T



4-Panels
Raised
#106



6-Panels
Raised
#108
RTH



Hard and heavy, Oak grows mainly in the North Central United States. With a coarse texture and a straight, prominent grain, oak accepts a broad range of stains and finishes.

Natural | Beautiful | Hardwood

Stile & Rail

Poplar Flat Panel Doors



**1-Panel
Flat
#4020**



**2-Panels
Flat
#4102
RTH**



**3-Panels
Flat
#4103T
RTH**



**3-Equal Panels
Flat
#4103**



**5-Equal Panels
Flat
#4107**



Poplar grows in the Eastern United States. Colors of Poplar vary from brown to pale yellow to olive green.

Natural | Beautiful | Fine Texture

Poplar Raised Panel Doors

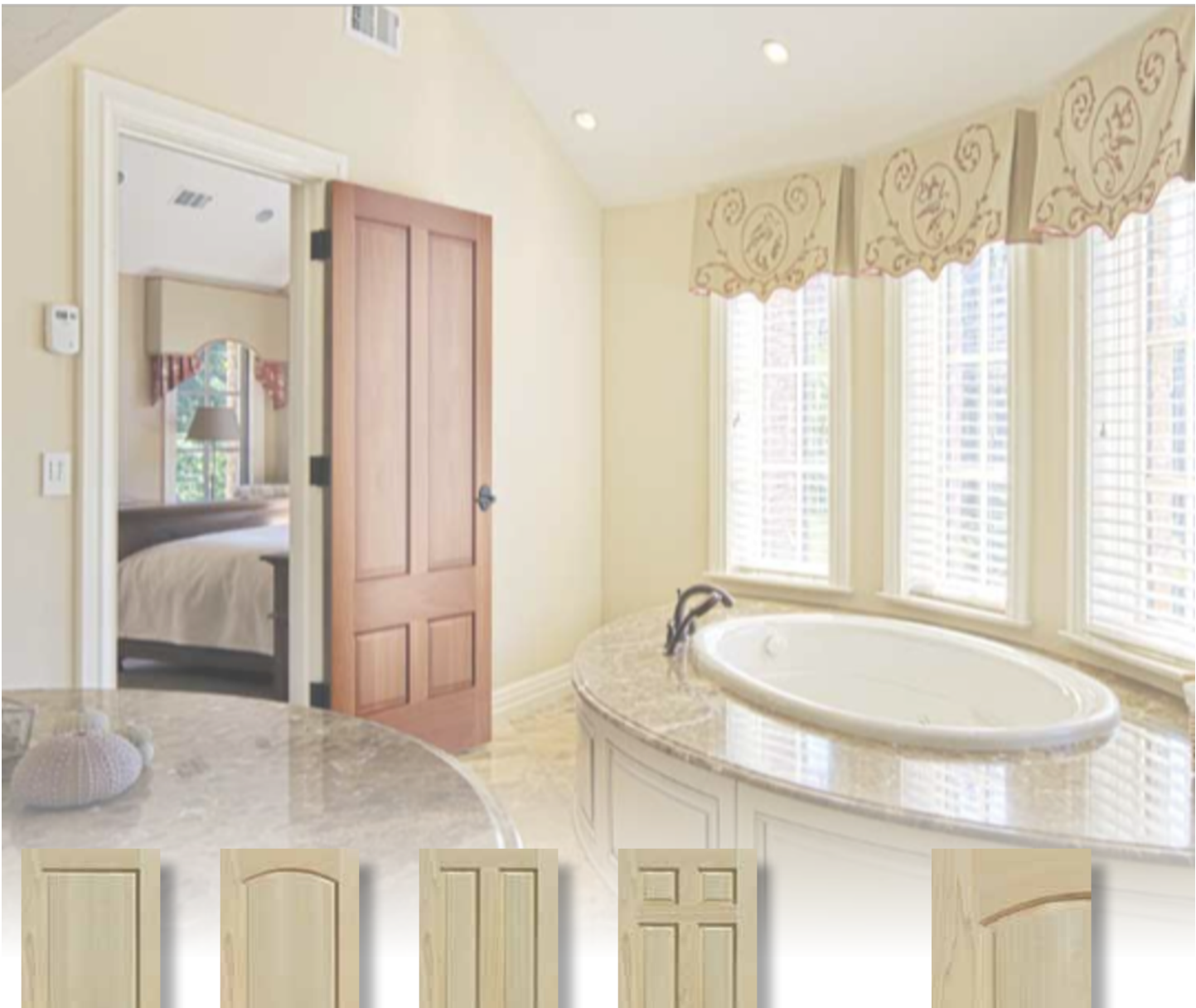

**2-Panels
Raised
#102**



**2-Panels
Raised
#802**



**4-Panels
Raised
#106**



**6-Panels
Raised
#108
RTH**

It is a medium density hardwood, generally straight-grained with a fine, even texture. Over time, the green color will darken with exposure to sunlight and may turn brown.

Natural | Beautiful | Fine Texture

Stile & Rail

Knotty Alder Flat Panel Doors



**2-Panels
Flat
KA2TM
RTH**



**3-Panels
Flat
KA3TM
RTH**



**3-Equal Panels
Flat
#4103**



**2-Panels
Planked
#102PLK**



**2-Panels
Planked
#802PLK**



**Z-Barn
Planked
#180Z**



**K-Barn
Planked
#181K**

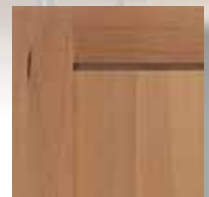

Knotty Alder grows in the Pacific Northwest and is a medium density hardwood with an even grain appearance.

Natural | Beautiful | Even Grain

Knotty Alder Raised Panel Doors



**2-Panel
Raised
#102**



**2-Panel
Raised
#802**

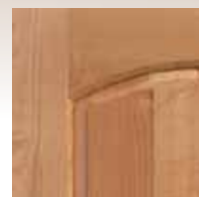

The wood is normally light brown with hues of red or peach. Its softer nature makes it easy to machine and receptive to a variety of stains and finishes.

Natural | Beautiful | Even Grain

Stile & Rail

Knotty Radiata Pine Doors

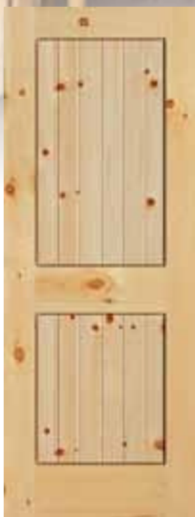

**2-Panels
Planked
#102 PLK**



**2-Panels
Planked
#802 PLK**



**3-Panels
Flat
#4103T**



**6-Panels
Raised
#108**



Radiata Pine is a plantation-grown wood from Chile, New Zealand and Australia. It has a distinctive grain pattern with a pale cream color. Radiata tends to be harder than other pine species and has fewer knots.

Natural | Beautiful | Distinctive Grain

Radiata Pine Doors



Radiata Pine is a plantation-grown wood from Chile, New Zealand and Australia. It has a distinctive grain pattern with a pale cream color. Radiata tends to be harder than other pine species and has fewer knots.



**2-Panels
Raised
#102**



**4-Panels
Raised
#106**



**6 -Panels
Raised
#108
*RTH***

Natural | Beautiful | Distinctive Grain

French Doors

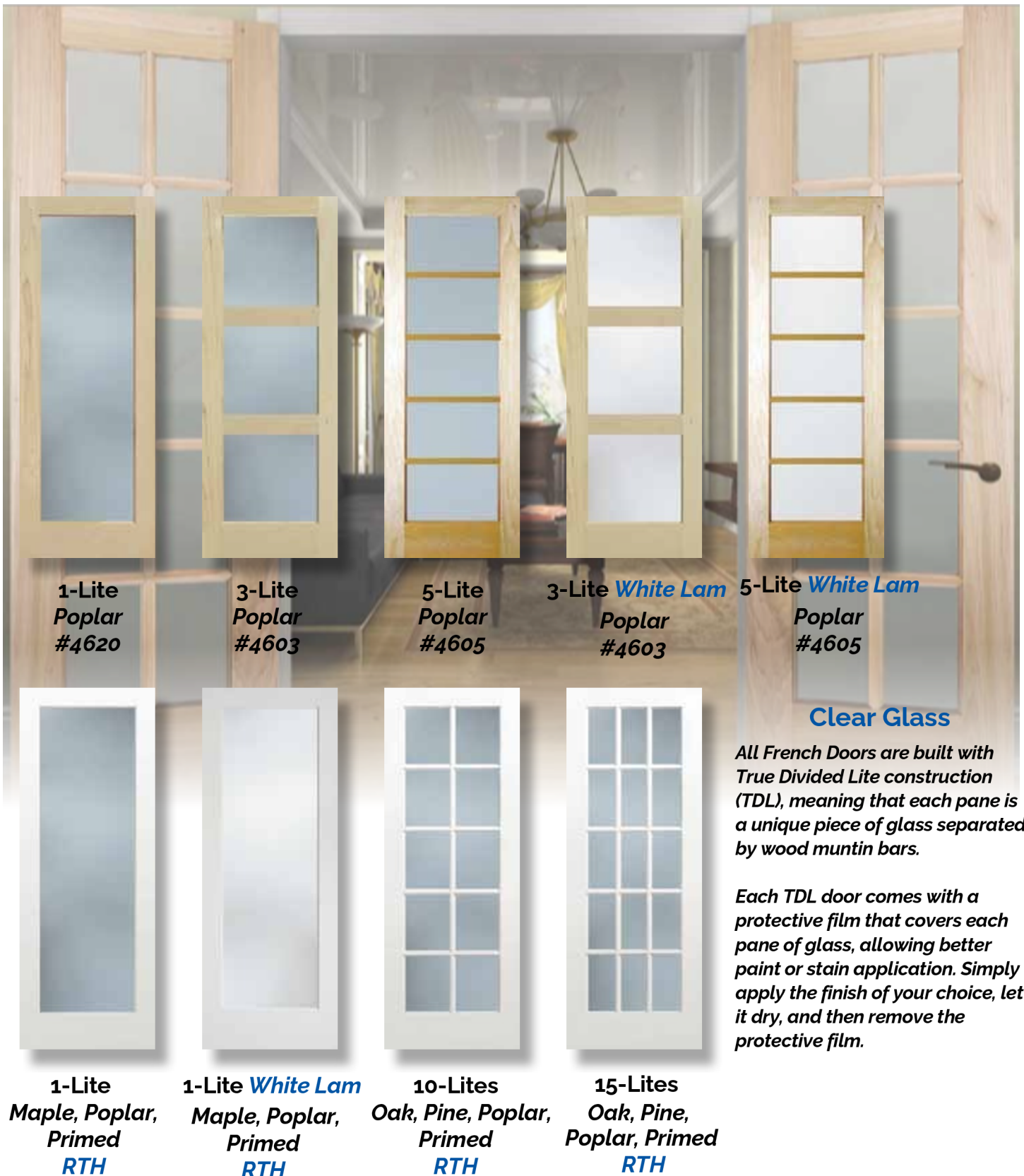

1-Lite Poplar #4620

3-Lite Poplar #4603

5-Lite Poplar #4605

3-Lite *White Lam* Poplar #4603

5-Lite *White Lam* Poplar #4605

Clear Glass

All French Doors are built with True Divided Lite construction (TDL), meaning that each pane is a unique piece of glass separated by wood muntin bars.

Each TDL door comes with a protective film that covers each pane of glass, allowing better paint or stain application. Simply apply the finish of your choice, let it dry, and then remove the protective film.

1-Lite Maple, Poplar, Primed RTH

1-Lite *White Lam* Maple, Poplar, Primed RTH

10-Lites Oak, Pine, Poplar, Primed RTH

15-Lites Oak, Pine, Poplar, Primed RTH

Elegance | Warmth | Beauty

French Door Glass Options

Not all sizes or glass options are available in all styles or species.



Artique



Beveled



Charcoal Sticks



Clear



Cotswold



Delta Frost



Frosted (Frit)



Glue Chip



Heavy Water



Mirror



Narrow Reed



Obscure



Rain



Ribbed



Seedy



Tafetta



V-Grooved

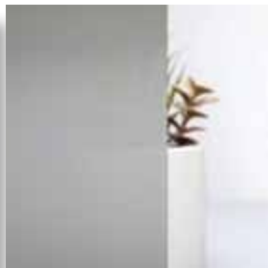

White Laminated



#42 Clear

Decorative | Flexible | Unique

Stock Doors & Sizes at DMD

| Door Style | Passage Doors | | | | | | | | | | |
|---|---------------|-----|-----|------|-----|-----|-----|-----|-----|------|-----|
| MOLDED PANEL DOORS - HC & SC | 1/4 | 1/6 | 1/8 | 1/10 | 2/0 | 2/2 | 2/4 | 2/6 | 2/8 | 2/10 | 3/0 |
| 2-Panel Square Top - Smooth Hollow Core - 6/8 x 1 $\frac{3}{8}$ " * | • | • | • | • | • | • | • | • | • | • | • |
| 2-Panel Roman - Smooth Hollow Core - 6/8 x 1 $\frac{3}{8}$ " | • | | | | • | • | • | • | • | • | • |
| 6-Panel - Smooth Hollow Core - 6/8 x 1 $\frac{3}{8}$ " | • | • | • | • | • | • | • | • | • | • | • |
| Craftsman III - Molded Hollow Core - 6/8 x 1 $\frac{3}{8}$ " | • | • | • | | • | • | • | • | • | • | • |
| 2-Panel Square Top - Smooth Solid Core - 6/8 x 1 $\frac{3}{8}$ " | • | • | • | • | • | • | • | • | • | • | • |
| **7/0 x 1 $\frac{3}{8}$ " ** | • | • | | | • | • | • | • | • | • | • |
| **8/0 x 1 $\frac{3}{4}$ " ** | • | • | | | • | • | • | • | • | • | • |
| 2-Panel Roman - Smooth Solid Core - 6/8 x 1 $\frac{3}{8}$ " | • | • | • | | • | • | • | • | • | • | • |
| 6-Panel - Smooth Solid Core - 6/8 x 1 $\frac{3}{8}$ " | • | • | • | | • | • | • | • | • | • | • |
| Craftsman III - Molded Solid Core - 6/8 x 1 $\frac{3}{8}$ " | • | • | • | | • | | • | • | • | • | • |
| Logan - Smooth Solid Core - 6/8 x 1 $\frac{3}{8}$ " | | • | | | • | | • | • | • | | • |

| Bifold Doors | | | | | | |
|--------------|--------|--------|--------|--------|--------|--|
| 2/0 BF | 2/6 BF | 3/0 BF | 4/0 BF | 5/0 BF | 6/0 BF | |
| • | • | • | • | • | • | |
| • | • | • | • | • | • | |
| • | • | • | • | • | • | |
| • | • | • | • | • | • | |
| | | | | | | |
| | | | | | | |
| | | | | | | |
| | | | | | | |
| | | | | | | |

| Door Style | Passage Doors | | | | | | | | | | |
|--|---------------|-----|-----|------|-----|-----|-----|-----|-----|------|-----|
| FLUSH SERIES DOORS | 1/4 | 1/6 | 1/8 | 1/10 | 2/0 | 2/2 | 2/4 | 2/6 | 2/8 | 2/10 | 3/0 |
| Birch - Flush Hollow Core - 6/8 x 1 $\frac{3}{8}$ " | | • | • | | • | | • | • | • | • | • |
| Birch Flush Solid Core - 6/8 x 1 $\frac{3}{8}$ " | | • | | | • | | • | • | • | • | • |
| **6/8 x 1 $\frac{3}{4}$ " ** | | | | | | | | | • | | • |
| Red Oak- Flush Hollow Core - 6/8 x 1 $\frac{3}{8}$ " | | • | • | | • | | • | • | • | • | • |
| Red Oak Flush Solid Core - 6/8 x 1 $\frac{3}{8}$ " | | • | | | • | | • | • | • | • | • |
| Primed Hardboard - Flush Hollow Core - 6/8 x 1 $\frac{3}{8}$ " | | • | | • | • | • | • | • | • | • | • |
| Primed Hardboard - Flush Solid Core - 6/8 x 1 $\frac{3}{8}$ " | | • | | | • | • | • | • | • | • | • |

| Bifold Doors | | | | | | |
|--------------|--------|--------|--------|--------|--------|--|
| 2/0 BF | 2/6 BF | 3/0 BF | 4/0 BF | 5/0 BF | 6/0 BF | |
| | | | | | | |
| | | | | | | |
| | | | | | | |
| • | • | • | • | • | • | |
| | | | | | | |
| • | • | • | • | • | • | |
| | | | | | | |

| Door Style | Passage Doors | | | | | | | | | | |
|---|---------------|-----|-----|------|-----|-----|-----|-----|-----|------|-----|
| PRIMED STILE AND RAIL DOORS | 1/4 | 1/6 | 1/8 | 1/10 | 2/0 | 2/2 | 2/4 | 2/6 | 2/8 | 2/10 | 3/0 |
| 1-Panel - #7910 - 6/8 x 1 $\frac{3}{8}$ " | | • | | | • | • | • | • | • | • | • |
| **7/0x1 $\frac{3}{8}$ " ** | | • | | | • | | • | • | • | • | • |
| **8/0x1 $\frac{3}{4}$ " ** | | • | | | • | | • | • | • | • | • |
| 2-Panel - #7920 - 6/8 x 1 $\frac{3}{8}$ " | | • | • | | • | • | • | • | • | • | • |
| **7/0x1 $\frac{3}{8}$ " ** | | • | | | • | | • | • | • | • | • |
| **8/0x1 $\frac{3}{4}$ " ** | | • | | | • | | • | • | • | • | • |
| 3-Panel - #793E - 6/8 x 1 $\frac{3}{8}$ " | | • | • | | • | | • | • | • | • | • |
| 5-Panel - #793H - 6/8 x 1 $\frac{3}{8}$ " | | • | | | • | | • | • | • | • | • |
| 5-Panel - #795H - 6/8 x 1 $\frac{3}{8}$ " | | • | | | • | | • | • | • | • | • |

| Bifold Doors | | | | | | |
|--------------|--------|--------|--------|--------|--------|--|
| 2/0 BF | 2/6 BF | 3/0 BF | 4/0 BF | 5/0 BF | 6/0 BF | |
| • | • | • | • | • | • | |
| | | | | | | |
| | | | | | | |
| • | • | • | • | • | • | |
| | | | | | | |
| | | | | | | |
| • | • | • | • | • | • | |
| • | • | • | • | • | • | |

Stock Doors & Sizes at DMD

| Door Style | | Passage Doors | | | | | | | | | | | Bifold Doors | | | | | |
|-----------------------------------|--|---------------|-----|-----|------|-----|-----|-----|-----|-----|------|-----|--------------|--------|--------|--------|--------|--------|
| MAPLE STILE AND RAIL DOORS | | 1/4 | 1/6 | 1/8 | 1/10 | 2/0 | 2/2 | 2/4 | 2/6 | 2/8 | 2/10 | 3/0 | 2/0 BF | 2/6 BF | 3/0 BF | 4/0 BF | 5/0 BF | 6/0 BF |
| 2-Panel Flat - #4102 - 6/8 x 1⅜" | | | • | | | • | | • | • | • | | • | | | | | | |
| 3-Panel Flat - #4103T - 6/8 x 1⅜" | | | • | | | • | | • | • | • | | • | | | | | | |

| | | | | | | | | | | | | | | | | | | |
|-----------------------------------|--|-----|-----|-----|------|-----|-----|-----|-----|-----|------|-----|--------|--------|--------|--------|--------|--------|
| OAK STILE AND RAIL DOORS | | 1/4 | 1/6 | 1/8 | 1/10 | 2/0 | 2/2 | 2/4 | 2/6 | 2/8 | 2/10 | 3/0 | 2/0 BF | 2/6 BF | 3/0 BF | 4/0 BF | 5/0 BF | 6/0 BF |
| 6-Panel Raised - #108 - 6/8 x 1⅜" | | | • | | | • | | • | • | • | • | • | • | • | • | • | • | • |

| | | | | | | | | | | | | | | | | | | |
|-----------------------------------|--|-----|-----|-----|------|-----|-----|-----|-----|-----|------|-----|--------|--------|--------|--------|--------|--------|
| PINE DOORS | | 1/4 | 1/6 | 1/8 | 1/10 | 2/0 | 2/2 | 2/4 | 2/6 | 2/8 | 2/10 | 3/0 | 2/0 BF | 2/6 BF | 3/0 BF | 4/0 BF | 5/0 BF | 6/0 BF |
| 6-Panel Raised - #108 - 6/8 x 1⅜" | | | • | | | • | | • | • | • | | • | | | | | | |

| | | | | | | | | | | | | | | | | | | |
|-----------------------------------|--|-----|-----|-----|------|-----|-----|-----|-----|-----|------|-----|--------|--------|--------|--------|--------|--------|
| POPLAR STILE AND RAIL DOORS | | 1/4 | 1/6 | 1/8 | 1/10 | 2/0 | 2/2 | 2/4 | 2/6 | 2/8 | 2/10 | 3/0 | 2/0 BF | 2/6 BF | 3/0 BF | 4/0 BF | 5/0 BF | 6/0 BF |
| 2-Panel Flat - #4102 - 6/8 x 1⅜" | | | • | | | • | | • | • | • | | • | | | | | | |
| 3-Panel Flat - #4103T - 6/8 x 1⅜" | | • | • | • | | • | | • | • | • | • | • | | | | | | |
| 6-Panel Raised - #108 - 6/8 x 1⅜" | | | • | • | | • | • | • | • | • | • | • | | | | | | |

| | | | | | | | | | | | | | | | | | | |
|-----------------------------------|--|-----|-----|-----|------|-----|-----|-----|-----|-----|------|-----|--------|--------|--------|--------|--------|--------|
| KNOTTY ALDER STILE AND RAIL DOORS | | 1/4 | 1/6 | 1/8 | 1/10 | 2/0 | 2/2 | 2/4 | 2/6 | 2/8 | 2/10 | 3/0 | 2/0 BF | 2/6 BF | 3/0 BF | 4/0 BF | 5/0 BF | 6/0 BF |
| 2-Panel Flat - #KA2TM - 6/8 x 1⅜" | | | • | | | • | | • | • | • | | • | | | | | | |
| 3-Panel Flat - #KA3TM - 6/8 x 1⅜" | | | • | | | • | | • | • | • | | • | | | | | | |

| Door Style | | Passage Doors | | | | | | | | | | | Bifold Doors | | | | | |
|---|--|---------------|-----|-----|------|-----|-----|-----|-----|-----|------|-----|--------------|--------|--------|--------|--------|--------|
| FRENCH DOORS | | 1/4 | 1/6 | 1/8 | 1/10 | 2/0 | 2/2 | 2/4 | 2/6 | 2/8 | 2/10 | 3/0 | 2/0 BF | 2/6 BF | 3/0 BF | 4/0 BF | 5/0 BF | 6/0 BF |
| 1-Lite Primed - Clear - 6/8 x 1⅜" | | | | | | • | | | • | • | | • | | | | | | |
| 1-Lite Primed - White Laminated - 6/8 x 1⅜" | | | | | | • | | | • | • | | • | | | | | | |
| 10-Lite Primed - Clear - 6/8 x 1⅜" | | | | | | • | | | | | | | | | | | | |
| 15-Lite Primed - Clear - 6/8 x 1⅜" | | | | | | | | | • | • | | • | | | | | | |
| 1-Lite Poplar - Clear - 6/8 x 1⅜" | | | | | | • | | | • | • | | • | | | | | | |
| 1-Lite Poplar - White Laminated - 6/8 x 1⅜" | | | | | | • | | | • | • | | • | | | | | | |
| 10-Lite Poplar - Clear - 6/8 x 1⅜" | | | | | | • | | | | | | | | | | | | |
| 15-Lite Poplar - Clear - 6/8 x 1⅜" | | | | | | | | | • | • | | • | | | | | | |
| 1-Lite Maple - Clear - 6/8 x 1⅜" | | | | | | • | | | • | • | | • | | | | | | |
| 1-Lite Maple - White Laminated - 6/8 x 1⅜" | | | | | | • | | | • | • | | • | | | | | | |
| 10-Lite Oak - Clear - 6/8 x 1⅜" | | | | | | • | | | | | | | | | | | | |
| 15-Lite Oak - Clear - 6/8 x 1⅜" | | | | | | | | | • | • | | • | | | | | | |
| 10-Lite Pine - Clear - 6/8 x 1⅜" | | | | | | • | | | | | | | | | | | | |
| 15-Lite Pine - Clear - 6/8 x 1⅜" | | | | | | | | | • | • | | • | | | | | | |

Updated December 11, 2025